

# EPSON® GT-30000

## Color Image Scanner

EN

All rights reserved. No part of this publication may be reproduced, stored in a retrieval system, or transmitted in any form or by any means, electronic, mechanical, photocopying, recording, or otherwise, without the prior written permission of SEIKO EPSON CORPORATION. No patent liability is assumed with respect to the use of the information contained herein. Neither is any liability assumed for damages resulting from the use of the information contained herein.

Neither SEIKO EPSON CORPORATION nor its affiliates shall be liable to the purchaser of this product or third parties for damages, losses, costs, or expenses incurred by purchaser or third parties as a result of: accident, misuse, or abuse of this product or unauthorized modifications, repairs, or alterations to this product.

SEIKO EPSON CORPORATION and its affiliates shall not be liable for any damages or problems arising from the use of any options or any consumable products other than those designated as Original EPSON Products or EPSON Approved Products by SEIKO EPSON CORPORATION.

EPSON is a registered trademark of SEIKO EPSON CORPORATION.

IBM and PS/2 are registered trademarks of International Business Machines Corporation.

Apple, Macintosh, Mac, iMac, and Power Macintosh are registered trademarks of Apple Computer, Inc.

Microsoft and Windows are registered trademarks of Microsoft Corporation in the United States of America and other countries.

Adobe and Acrobat Reader are registered trademarks of Adobe Systems Incorporated.

ISIS is a registered trademark of Pixel Translations, a Division of ActionPoint, Inc.

**General Notice:** *Other product names used herein are for identification purposes only and may be trademarks of their respective companies.*

Copyright © 2000 by SEIKO EPSON CORPORATION, Nagano, Japan.

## Quick Start Manual

---



---

## ■ Table of Contents

<b>Where to Find Information</b> .....	<b>4</b>
<b>ENERGY STAR Compliance</b> .....	<b>5</b>
<b>Warnings, Cautions, and Notes</b> .....	<b>5</b>
<b>System Requirements</b> .....	<b>5</b>
For Windows and SCSI users .....	5
For Windows and IEEE 1394 users .....	6
For scanning over a network .....	6
<b>Scope of Delivery</b> .....	<b>7</b>
<b>Choosing a Place for the Scanner</b> .....	<b>8</b>
<b>Releasing the Transportation Lock</b> .....	<b>8</b>
<b>Plugging In the Scanner</b> .....	<b>9</b>
<b>Initializing the Scanner</b> .....	<b>10</b>
<b>Connecting the Scanner to Your PC Using the SCSI Interface</b> .....	<b>10</b>
Understanding SCSI connections .....	11
Setting the SCSI ID number .....	12
Setting the terminator switch .....	12
Setting the select switch .....	13
Connecting the scanner .....	14
Power-on sequence .....	15
Power-off sequence .....	15
<b>Installing EPSON TWAIN HS</b> .....	<b>16</b>
For Windows Millennium Edition users .....	16
For Windows 98 and 2000 users .....	18
For Windows 95 and NT 4.0 users .....	19
<b>Calibrating Your Screen</b> .....	<b>21</b>
<b>Using the Online Manuals</b> .....	<b>22</b>
Installing Adobe Acrobat Reader .....	23
Accessing the online manuals .....	24
<b>Customer Support</b> .....	<b>24</b>

---

## ■ Where to Find Information

### ■ Quick Start Manual (this manual)

This guide provides you with information and instructions on how to unpack and set up your scanner. Here you will also find instructions on using the online documentation provided on CD-ROM.

### ■ Setup Guide (online)

Describes how to set up and use the scanner. Basic scanning operations are covered. It also explains how to install and configure the EPSON scanner software and the Automatic Document Feeder, and includes information on how to calibrate your system. The guide describes how to make basic software settings, use the Start Button function, and scan images in a networked environment.

### ■ Reference Guide (online)

Provides basic information about scanning, detailed reference on settings and functions of EPSON TWAIN HS and other EPSON scanner utility software, troubleshooting tips, and customer support information. Explanations about EPSON TWAIN HS also apply to EPSON TWAIN HS Network. It also explains how to set up the scanner server PC.

### ■ Information on EPSON TWAIN HS and EPSON TWAIN HS Network (online help)

Provides you with detailed information on EPSON TWAIN HS and EPSON TWAIN HS Network. To display the online help, click the **Help** button in the dialog box of EPSON TWAIN HS or EPSON TWAIN HS Network.

### ■ Information on ISIS driver

Refer to the respective documentation provided on the EPSON Scanner Software CD-ROM.

---

## ■ ENERGY STAR Compliance

As an ENERGY STAR Partner, EPSON has determined that this product meets the ENERGY STAR guidelines for energy efficiency.



The International ENERGY STAR Office Equipment Program is a voluntary partnership with the computer and office equipment industry to promote the introduction of energy-efficient personal computers, monitors, printers, fax machines, copiers, and scanners, in an effort to reduce air pollution caused by power generation.

---

## ■ Warnings, Cautions, and Notes



### Warnings

*must be followed carefully to avoid bodily injury.*



### Cautions

*must be observed to avoid damage to your equipment.*

### Notes

*contain important information and useful tips on the operation of your scanner.*

---

## ■ System Requirements

Before installing the scanner software, make sure that your system meets the following requirements.

### ■ For Windows and SCSI users

Scanner: EPSON GT-30000

System: Microsoft® Windows® 95, Windows 98, Windows Millennium Edition, Windows 2000 Professional, or Windows NT® 4.0 Workstation

Interface: SCSI adapter

Display: VGA or higher resolution monitor 640 × 480 pixel resolution (800 × 600 or higher recommended), with High Color (16bit) or True Color (32bit) setting

**Note:**

*Color and tone reproduction are subject to the display capability of your computer system, including the video card, display monitor, and software. See the product documentation for details.*

## ■ For Windows and IEEE 1394 users

Scanner: EPSON GT-30000

System: Microsoft Windows Millennium Edition, or Windows 2000 Professional pre-installed

Interface: IEEE 1394 adapter

Display: VGA or higher resolution monitor 640 × 480 pixel resolution (800 × 600 or higher recommended), with High Color (16bit) or True Color (32bit) setting

**Note:**

*Color and tone reproduction are subject to the display capability of your computer system, including the video card, display monitor, and software. See the product documentation for details.*

## ■ For scanning over a network

Computer:

**For EPSON Scan Server**

IBM PC/AT compatible computer (Intel Pentium or faster processor is recommended)

**For EPSON TWAIN HS Network**

IBM PC/AT compatible computer (Intel Pentium or faster processor is recommended)

Operating System:	<p><b>For EPSON Scan Server</b>  Microsoft Windows 95, Windows 98, Windows Millennium Edition, Windows 2000 Professional/Server, or Windows NT 4.0 Workstation/Server</p> <p><b>For EPSON TWAIN HS Network</b>  Microsoft Windows 95, Windows 98, Windows Millennium Edition, Windows 2000 Professional, or Windows NT 4.0 Workstation</p>
System Configuration:	Minimum two computers on the network
Scanner:	EPSON GT-30000
Hardware Interface for Scanner:	SCSI, IEEE 1394 (IEEE 1394 is available on Windows Millennium Edition and Windows 2000 preinstalled only)
Hardware Interface for Networking:	10BASE-T/100BASE-TX, 10BASE-5, 10BASE-2
Ethernet Communication Protocol:	TCP/IP



---

## ■ Scope of Delivery

Make sure you have all the parts listed below:

- Scanner
- Power cord
- Automatic Document Feeder
- 2 knobs
- 2 installation screws
- screwdriver
- CD-ROM

---

## ■ Choosing a Place for the Scanner

Follow the guidelines below when selecting a location for your scanner:

- Place the scanner on a flat, stable surface. The scanner will not operate properly if it is tilted at an angle.
- Place the scanner close enough to the computer for the interface cable to reach it easily.
- Place the scanner near a wall outlet where the power cord can be easily unplugged.
- Allow space behind the scanner for the cables, and space above the scanner so that you can raise the Automatic Document Feeder fully.

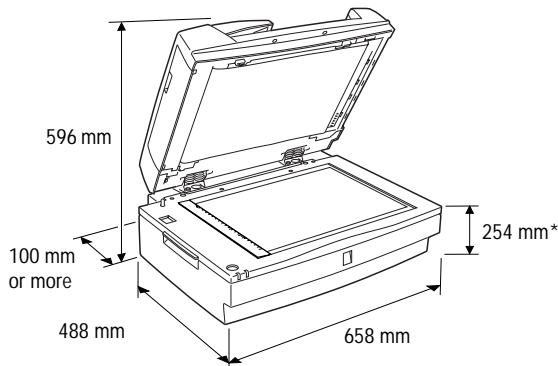

\* When Automatic Document Feeder is closed.

- Keep the scanner away from high temperatures, humidity and excessive dirt or dust. Also avoid using or storing the scanner in places subject to rapid changes of temperature and humidity.
- Keep the scanner away from direct sunlight and strong light sources.
- Avoid places subject to shocks and vibrations.

---

## ■ Releasing the Transportation Lock

Before installing the Automatic Document Feeder and connecting the scanner to a power source, you must release the transportation lock.

1. Place the scanner on a flat, stable surface with its back side facing you.
2. While pushing the transportation lock button, turn it counterclockwise to the unlocked position, using a coin or similar disc as shown below.



The button is flush with the surface of the scanner.

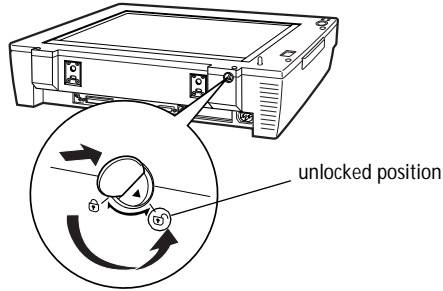

**Note:**

*Before you transport the scanner or store it for an extended period of time, secure the carriage by turning the transportation lock button clockwise while pushing it. When the transportation lock button is locked, the button goes down.*

## ■ Plugging In the Scanner

1. Make sure that the scanner is turned off. The scanner is off when the **OPERATE** button is raised (not depressed).

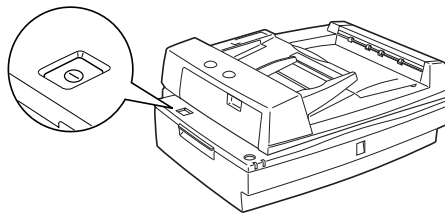

2. If the power cord is not attached to the scanner, connect it to the AC socket on the back of the scanner, and plug the other end into a properly grounded wall outlet.

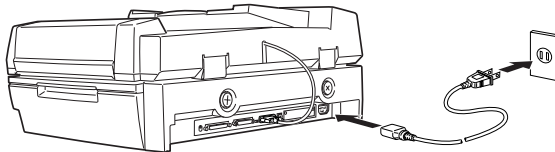

**Caution:**

*It is not possible to change the scanner's voltage. If the label on the back of the scanner does not show the correct voltage for your country, contact your dealer. Do not plug in the power cord.*

---

## ■ Initializing the Scanner

Before connecting the scanner to your PC, follow the steps below to make sure that the scanner is operating properly.

1. Open the Automatic Document Feeder so you can see the operation of the scanner during initialization.
2. Turn on the scanner by pressing the **OPERATE** button.

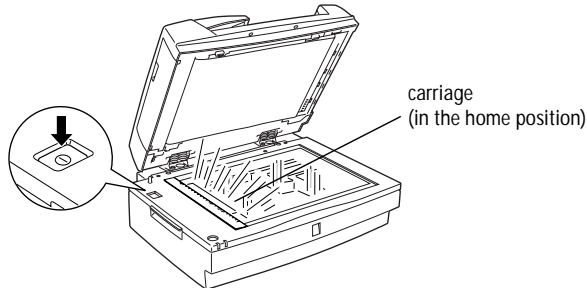

3. Make sure the carriage moves slightly to the right and then back to its original position, and the fluorescent lamp on the carriage flashes.

The **READY** light comes on, meaning the scanner has completed initialization.

4. Turn off the scanner.

If the scanner does not work as described, turn it off. Make sure the power cord is firmly plugged in and that you have released the transportation lock, then try again.



### **Caution:**

*Whenever you turn off the scanner, wait at least 10 seconds before turning it back on. Rapidly turning the scanner on and off can damage the scanner.*

---

## ■ Connecting the Scanner to Your PC Using the SCSI Interface

For instructions on connecting the scanner to your PC using the SCSI interface, read this section.

Unless your PC already has a SCSI board installed, you need to install one, along with SCSI driver software. Install the SCSI board according to the directions included with it.

If your PC has a SCSI board up and running, connect the scanner as described in the next section.

**Note:**

- *You will need to install the SCSI driver that is normally included with Windows 95, 98, Millennium Edition, NT (see your system documentation for instructions), or 2000, or the driver described in the SCSI board installation documentation.*
- *If you are having errors or poor performance, an updated driver may help. The latest driver may be available for download from the Web site of the SCSI board manufacturer.*

## ■ Understanding SCSI connections

Read the following sections to determine how to set up your SCSI devices and whether you need any optional SCSI cables.

### ***Daisy chain***

The SCSI interface allows you to connect up to seven devices (such as a scanner, hard drive, CD-ROM, and so on) to the computer, in what is called a “daisy chain” arrangement. Only the first SCSI device in a daisy chain is connected to the computer; each of the other devices is connected to another SCSI device.

**Note:**

*To work with a scanner in wide SCSI, the scanner must be connected to the wide SCSI Host Adapter via a 68-pin SCSI cable. If narrow SCSI devices exist between the SCSI host adapter and the scanner, the scanner works only in the narrow SCSI mode. In this case, you need to set the select switch to N (narrow).*

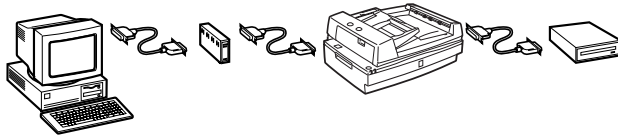

### ***SCSI cables***

You may need to purchase SCSI cables before setting up your SCSI daisy chain. The scanner has two SCSI connectors: one is for a wide 68-pin SCSI cable and the other for a narrow 50-pin SCSI cable. Be sure the SCSI cable connectors are suitable for your hardware, according to the maker of your SCSI device and SCSI interface board.

### ***SCSI ID and terminator***

Each device has a SCSI ID number: the computer is usually set to number 7, and each of the other devices must have a different number between 0 and 6. Also, the first device and the last device in the chain (not including the computer) must have a terminator. No other device can have a terminator, or if a terminator does exist, it must be turned off or removed.

## ■ Setting the SCSI ID number

The scanner's default SCSI ID number is 2.

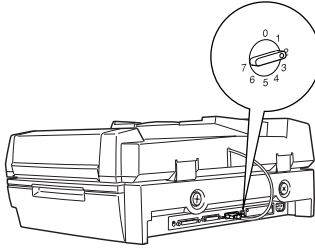

The SCSI ID rotary switch is located at the rear of the scanner.

If you add the scanner to a system in which one of your SCSI devices already has a SCSI ID of 2, change the ID number to an unused number using the rotary switch. See the table below as a guide.

ID	Availability	Description
0	Not recommended	Usually used for hard disk
1	Not recommended	Usually used for hard disk
2		Factory setting of the scanner
3		
4		
5		
6		
7	May not be available	Usually used for the SCSI board



### **Caution:**

*Do not set the SCSI ID to an ID number that is already assigned to another device; otherwise the PC, scanner, and other devices will not operate properly.*

## ■ Setting the terminator switch

The scanner has a built-in terminator, which allows SCSI devices to communicate properly with each other. You may need to change the terminator switch setting according to your computer system.

### **Note:**

*Do not use an external terminator.*

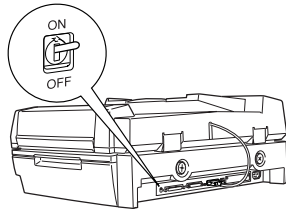

The terminator switch is located at the rear of the scanner.

Only the scanner is connected

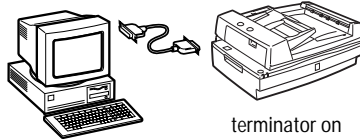

terminator on

The scanner is the last device in the daisy chain

(other SCSI device)

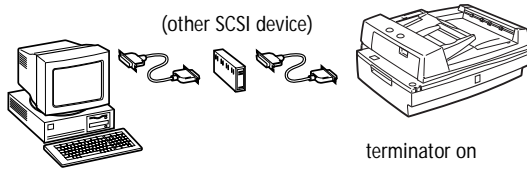

terminator on

The scanner is in the middle of the daisy chain

(other SCSI device)

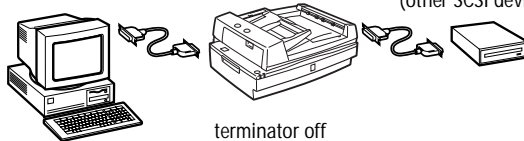

terminator off

## ■ Setting the select switch

The scanner has two SCSI connectors: one is for a wide 68-pin SCSI cable and the other for a narrow 50-pin SCSI cable. You may need to change the select switch setting according to the SCSI cable you are using.

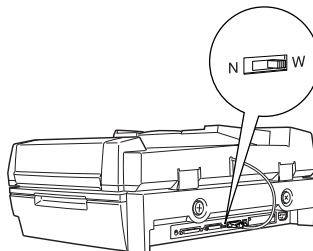

You may need to change the select switch setting according to the SCSI device connection.

Select switch	SCSI cable
N	Host adapter is wide SCSI, and there are 50-pin SCSI cables between host adapter and scanner.
W (default)	Except above connection.

## ■ Connecting the scanner

Use the following steps to connect the scanner to your PC or to another SCSI device.

### Note:

*The combination of connectors on the SCSI interface cable you need varies depending on the maker of your SCSI device and SCSI interface board.*

1. Make sure the scanner, your PC, and all other SCSI devices are turned off and unplugged from the power source.



### Caution:

*Do not connect the scanner to your PC or other devices while they are turned on, otherwise damage may occur.*

2. Connect one end of the interface cable to a suitable scanner SCSI connector until the locks on both sides snap in.

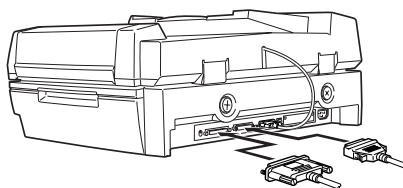

### Note:

- *To connect the scanner to a PC or any other SCSI device, the total length of cable in the daisy chain must not exceed 3 meters; otherwise the system may not work properly.*
  - *Make sure no other interface is used.*
  - *Before connecting the scanner to a PC, you need to set the select switch. See “Setting the select switch” on page 13 for details.*
3. Connect the other end of the cable to the SCSI port of your PC or another SCSI device.

4. Plug in the power cords of your PC, the scanner, and other external SCSI devices.

**Note:**

*Before turning on your system, be sure to read "Power-on sequence" following.*

## ■ Power-on sequence

Keep the following in mind every time you turn on your PC and SCSI devices, including the scanner.

- Be sure to turn on the SCSI devices first and your PC last. If you turn on a SCSI device after your PC, the SCSI device or your PC may not work properly.
- **For Windows 95, 98, 2000, or Millennium Edition users:**  
The first time you turn on your PC after the scanner, one of the following dialog boxes or similar may appear.



Windows 95



Windows 98



Windows 2000



Windows Millennium Edition

If you see one of these, follow the installation instructions as described in “Installing EPSON TWAIN HS” on page 16, then see “Power-off sequence” following.

## ■ Power-off sequence

Keep the following in mind every time you turn off your PC and SCSI devices.

- When you are finished using your system, turn off your PC first, then the scanner and other SCSI devices.
- While using your PC, do not turn off any SCSI device which has a terminator that is active (on).

- Do not turn the scanner off and back on while using your PC, otherwise the scanner may not work properly.

When the connection is complete, you need to install the scanner software, as described in “Installing EPSON TWAIN HS” on page 16.

---

## ■ Installing EPSON TWAIN HS

After connecting the scanner to your PC, install the scanner software (EPSON TWAIN HS) from the CD-ROM. The installation steps differ depending on the version of Windows.

For Windows Millennium Edition users, see the instructions following.

For Windows 98 and 2000 users, see “For Windows 98 and 2000 users” on page 18.

For Windows 95 and NT 4.0 users, see “For Windows 95 and NT 4.0 users” on page 19.

### Note:

- *If the scanner software is already installed and you are upgrading your system to Windows 98, 2000, or Millennium Edition, be sure to uninstall it before the upgrade, and then re-install it using the same steps described in this section. For more information, see chapter 4 “Maintenance and Troubleshooting” in your online Reference Guide.*
- *To install the scanner software in Windows 2000 or NT 4.0, you need to log on to Windows as an Administrator.*

## ■ For Windows Millennium Edition users

### Note:

*If you use the Scanner and Camera Wizard to select a scanner driver, EPSON recommends selecting the EPSON TWAIN driver to scan images, not the “WIA” driver provided with Windows Millennium Edition. See Windows online help for details on the Scanner and Camera Wizard.*

1. Connect your scanner to your PC.
2. Turn on the scanner, then your PC.

### Note:

*It is important to follow this power-on sequence if you are using a SCSI interface. Otherwise the Plug and Play feature will not work.*

3. When the **Add New Hardware Wizard** dialog box appears, select the **Specify the location of the driver** option, then click **Next**.
4. Insert your scanner software CD-ROM in the CD-ROM drive.



5. Make sure the **Search for the best driver for your device** option and the **Specify a location** check box are selected. Next, browse the CD-ROM for **EPSON\your preferred language)WINME**, then click **Next**.



6. When the dialog box shown below appears, click **Next**.



7. The EPSON Screen Calibration utility automatically starts. Follow the instructions on the screen. For details, see “Calibrating Your Screen” on page 21.

**Note:**

*If the EPSON Screen Calibration utility does not start automatically, see your online Reference Guide to calibrate your screen after installing the scanner software.*

8. When a dialog box appears informing you that Windows has finished the software installation, click **Finish**.
9. This completes the EPSON TWAIN HS installation. Restart your PC.

**Note:**

*It is important to restart your PC before using the scanner.*

See chapter 3 in your online *Setup Guide* to install the other utility and applications from the scanner software CD-ROM: to install EPSON Scan Server and EPSON TWAIN HS Network, see "Software for Scanning over a Network", and to install the ISIS<sup>®</sup> driver, see "Installing Another Application Software".

## ■ For Windows 98 and 2000 users

1. Connect your scanner to your PC.
2. Turn on the scanner, then your PC.

**Note:**

*It is important to follow this power-on sequence if you are using a SCSI interface. Otherwise the Plug and Play feature will not work.*

3. When the **Add New Hardware Wizard** (for Windows 98) or the **Found New Hardware Wizard** (for Windows 2000) appears, insert the scanner software CD-ROM in the CD-ROM drive, then click **Next**.
4. Select the **Search for the best driver for your device** option (for Windows 98) or the **Search for a suitable driver for my device** option (for Windows 2000), then click **Next**.
5. Make sure only the **Specify a location** check box is selected, then proceed to step 6 (for Windows 98) or click **Next** (for Windows 2000) before proceeding to step 6.
6. Browse and select, or type in the CD-ROM drive letter, the **EPSON** folder, the folder of your preferred language, and the **Win98** or **Win2000** folder as the location, as shown below. Finally, click **Next** (for Windows 98) or **OK** (for Windows 2000).



Windows 98



Windows 2000

7. Follow the instructions on the screen.

**For Windows 98 users:**

You may be asked to insert the Windows 98 CD-ROM. If so, replace the scanner software CD-ROM with the Windows 98 CD-ROM. Make sure that the correct CD-ROM drive letter and the **Win98** folder are specified in the **Copy files from:** box.

After installing the appropriate files, replace the Windows 98 CD-ROM with the scanner software CD-ROM.

**For Windows 2000 users:**

Click **Yes** in the dialog box that appears to continue.

**Note:**

*If you click **No** and stop installation, your scanner will appear under Other Devices with a question (?) mark in the Device Manager menu. You must reinstall EPSON TWAIN HS. Follow the instructions in chapter 4 "Maintenance and Troubleshooting" in your online Reference Guide.*

8. The EPSON Screen Calibration utility automatically starts. Follow the instructions on the screen. For details, see "Calibrating Your Screen" on page 21.

**Note:**

*If the EPSON Screen Calibration utility does not start automatically, see your online Reference Guide to calibrate your screen after installing the scanner software.*

9. When a dialog box appears informing you that Windows has finished the installation, click **Finish**.

**Note:**

*If necessary, restart your PC.*

This completes the EPSON TWAIN HS installation. See chapter 3 in your online *Setup Guide* to install the other utility and applications from the scanner software CD-ROM: to install EPSON Scan Server and EPSON TWAIN HS Network, see "Software for Scanning over a Network" and to install the ISIS<sup>®</sup> driver, see "Installing Another Application Software".

## ■ For Windows 95 and NT 4.0 users

1. Make sure that the scanner is turned on.
2. Turn on the PC, and start Windows.

If you are using Windows NT 4.0, insert the scanner software CD-ROM in the CD-ROM drive, then go to step 3.

For Windows 95, either of the following dialog boxes appears.

- If the following dialog box appears, insert the scanner software CD-ROM in the CD-ROM drive, then click **Next**.



When prompted for the drive and folder, select the CD-ROM drive, the **EPSON** folder, the folder of your preferred language, and the **Win95** folder.

When a dialog box appears informing you that an updated EPSON GT-30000 driver has been found, click **Finish** and go to step 3.

- If the following dialog box appears, insert the scanner software CD-ROM in the CD-ROM drive.



Select **Driver from disk provided by hardware manufacturer**. Click **OK** then **Browse**.

Select the CD-ROM drive, the **EPSON** folder, the folder of your preferred language, and the **Win95** folder. Finally click **OK** and go to step 3.

3. Double-click the **My Computer** icon.
4. Double-click the CD-ROM drive icon. A dialog box asking for your preferred language appears. If no dialog box appears, double-click the **Cdsetup.exe** icon.

5. Select your preferred language and click **OK**.
6. When the **EPSON Software Setup** dialog box appears, click **Add Software**.
7. From the list of applications, select those you want to install. Make sure EPSON TWAIN HS is selected for installation.
8. Click **OK**. Then follow the instructions on the screen.

The setup program installs EPSON TWAIN HS.

9. After EPSON TWAIN HS is installed, the EPSON TWAIN HS dialog box appears.
10. Make sure that **SCSI** is selected and your EPSON scanner appears in the Scanner Selection list. If not, see chapter 4 "Maintenance and Troubleshooting" in your online *Reference Guide*.
11. Click **Test** to check the connection. If everything is properly installed and connected, **Status: Device Ready** appears under **Scanner Information** in the dialog box.

If the "Device Ready" message does not appear, see chapter 4 "Maintenance and Troubleshooting" in your online *Reference Guide*.

12. Click **OK** to close the EPSON TWAIN HS dialog box.

The EPSON Screen Calibration utility automatically starts. Go to "Calibrating Your Screen" on page 21.

This completes the EPSON TWAIN HS installation. See chapter 3 in your online *Setup Guide* to install the other utility and applications from the scanner software CD-ROM: to install EPSON Scan Server and EPSON TWAIN HS Network, see "Software for Scanning over a Network" and to install the ISIS<sup>®</sup> driver, see "Installing Another Application Software".

---

## ■ Calibrating Your Screen

You must calibrate your screen and the scanner to reproduce images identical to the originals.

### **Note for Windows 98, 2000, and Millennium Edition users:**

*There is no introductory Screen Calibration dialog for Windows 98, 2000, and Millennium Edition. Start from step 2 to calibrate your screen.*

During the EPSON scanner software installation, the following dialog box appears.



1. Click **Next**.
2. In a dialog box similar to the one shown below, move the slider to the right or left until the two shades of the gray horizontal stripes match.

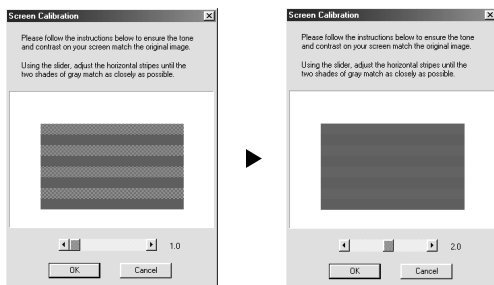

**Note:**  
*View the screen from a short distance. While the gray stripes do not blend perfectly well, try to adjust until the different tones match as closely as possible.*

3. Click **OK** to register the calibration setting.
4. When the message **Setup is complete** appears, click **OK**.

Screen calibration is not required any more until you change to a different monitor.

---

## ■ Using the Online Manuals

The CD-ROM shipped with your scanner includes online manuals in PDF format (PDF = Portable Document Format). PDF files can be used on various platforms (e.g. Windows, Macintosh, Unix, etc.) and are electronic manuals with the same layout, illustrations, tables etc. to be found in a printed manual. You can display an online manual on your computer screen and print it out on any connected printer, if required. The following online manuals are available:

- **Setup Guide**  
Describes how to set up and use the scanner. Basic scanning operations are covered. It also explains how to install and configure the EPSON scanner software and the Automatic Document Feeder, and includes information on how to calibrate your system. The guide describes how to make basic software settings, use the Start Button function, and scan images in a networked environment.
- **Reference Guide**  
Provides basic information about scanning, detailed reference on settings and functions of EPSON TWAIN HS and other EPSON scanner utility software, troubleshooting tips, and customer support information. Explanations about EPSON TWAIN HS also apply to EPSON TWAIN HS Network. It also explains how to set up the scanner server PC.
- **ISIS® Driver for EPSON GT-3000 Color Image Scanner**  
Contains information on installing the ISIS driver and making scanner settings. You will find this manual on the EPSON Scanner Software CD-ROM.

To access an online manual you need to install Adobe® Acrobat® Reader™ on your system. The Adobe Acrobat Reader program is an easy-to-use application program for displaying and printing online manuals. It offers a wide range of features which allow you to use the online manuals without difficulty to find any desired information. You can read the information online on your computer screen or print it out on your printer for later reference. If you need complete information on the Adobe Acrobat Reader, refer to its online help.

If the Acrobat Reader is already installed on your system, you can skip the next section.

**Note:**

*If the Adobe Acrobat Reader is not installed on your system, the manual will not open and an error message will be displayed.*

## ■ Installing Adobe Acrobat Reader

1. Insert the EPSON manual CD-ROM into your computer's CD-ROM drive.

The setup program on the CD-ROM will be started automatically and displays the start screen. If the setup program is not started automatically, click the **Start** button, then click **Run** and enter the command **E:\Start.exe** to start the setup program.

**Note:**

*If your CD-ROM drive has a drive letter other than **E**, substitute the appropriate letter.*

2. Select the preferred language.
3. Select **Online manuals**, followed by **Install Acrobat Reader** and follow the on-screen instructions.

After the Acrobat Reader has been installed on your system, you can access the online manuals.

## ■ Accessing the online manuals

The setup program on the CD-ROM offers two possibilities to access the online manuals: from the CD-ROM or from your computer hard disk.

### **Note:**

*Before you can access the online manual from your hard disk, you first have to install it on your system.*

1. Insert the EPSON manual CD-ROM into your computer's CD-ROM drive.

The setup program on the CD-ROM will be started automatically and displays the start screen. If the setup program is not started automatically, click the **Start** button, then click **Run** and enter the command **E:\Start.exe** to start the setup program.

### **Note:**

*If your CD-ROM drive has a drive letter other than **E**, substitute the appropriate letter.*

2. Select the preferred language.
3. Select **Online manuals**. The setup program displays the names of the available online manuals.
4. Select **manual name - Read** if you wish to open the manual from the CD-ROM. Acrobat Reader will be started automatically and the online manual opened.

### **Note:**

*If you wish to copy the online manual to your system's hard disk, select **manual name - PC installation**. You can delete the manual from the hard disk at a later date if you wish.*

*Once the manuals have been installed on the hard disk, click the **Start** button, point to **Programs**, then point to **EPSON**. Click on the name of the online manual. The Acrobat Reader will be started automatically and the online manual opened.*

---

## ■ Customer Support

EPSON's Service and Support hotline is available should you require urgent help. You will find the telephone number and further important information for your country in the Service and Support brochure provided with your scanner.