

Be sure to read the accompanying User's Guide before using the projector.

WARNING

Do not look into the lens while the projector's power is turned on.

Adjusting the Image Size



User's Guide
"Screen Size and Projection Distance"

The size of the projected image is basically determined by the distance from the lens to the screen. The actual values will vary depending on projection conditions and the zoom setting. The values should be used as a guide for setting up the projector.

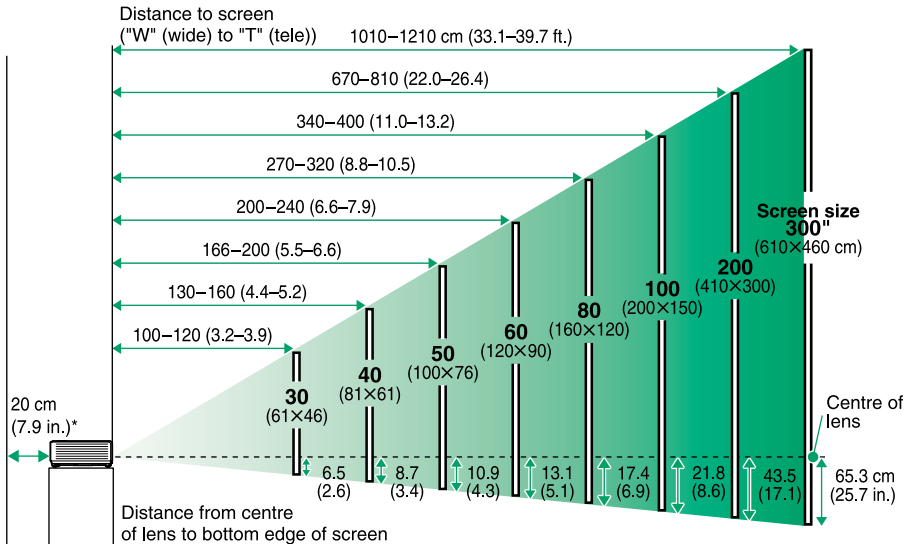

* When installing against a wall, leave about 20 cm (7.9 in.) between the projector and the wall.

Connecting to a Computer



User's Guide
"Connecting to a Computer"

Turn off the power for both the projector and the computer before connecting them.

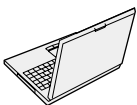

To computer monitor port

To [Computer/Component Video] port (blue)

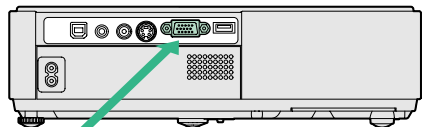

Computer cable (accessory)

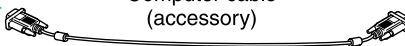

Tip

The computer cable supplied with the projector may not match the monitor port on some computers. In such cases, you will need to purchase a separate adapter.

Connecting to a Video Source

User's Guide
"Connecting to a Video Source"

Turn off the power for both the projector and the video source before connecting them.

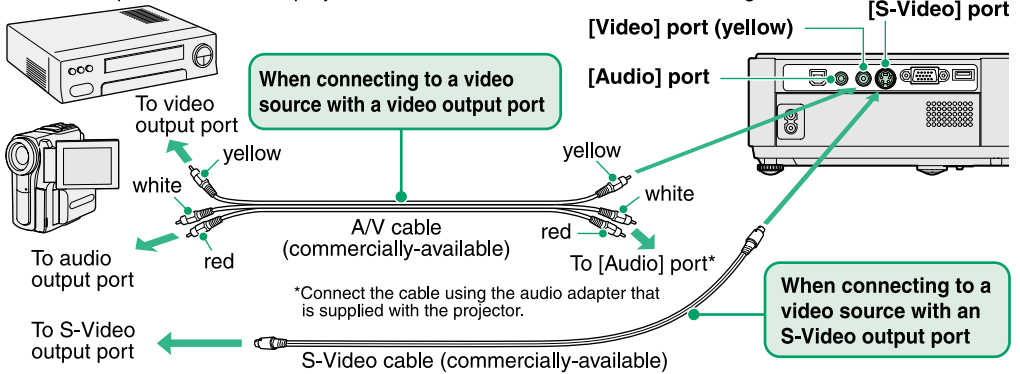

To play sound through the projector's built-in speaker, use the audio adapter (supplied with the projector) to connect an A/V cable (commercially available) to the [Audio] input port corresponding to the connected video source.



Tip

If connecting a component video source (such as a DVD player), you can use the optional component video cable to connect the source to the Computer/Component Video port at the rear of the projector.

Preparation before Projecting

User's Guide
"Turning the Projector On"

- 1 Remove the lens cover.**
- 2 Insert the projector's power cable into the projector.**
- 3 Insert the power cable into an earthed electrical outlet.**
The Power indicator will light orange.
- 4 Turn on the power for the signal input source.**
For video equipment, press [Play] to start playback.
- 5 Press to turn on the projector's power.**
A beep will sound to indicate that the projector is starting up.
The Power indicator will flash green, and projection will then start (warm-up in progress).
The Password Protect setting may cause the password entry screen to be displayed each time the power is turned on.
If this happens, enter the password.
 User's Guide "Preventing theft (Password Protect)"
When the "Extended" - "Operation" - "Direct Power ON" menu item is set to "ON", a confirmation buzzer sounds and the projector's power turns on as soon as the power plug is inserted into the electrical outlet, and projection then starts.
 User's Guide "Extended" Menu

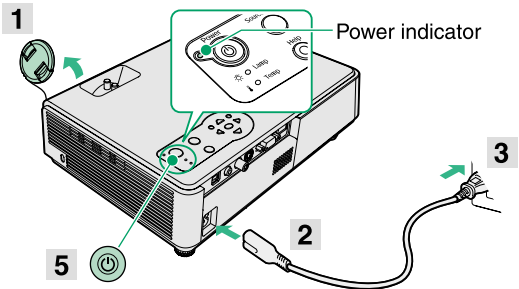

Tip

- If no images are projected, change the input signal.

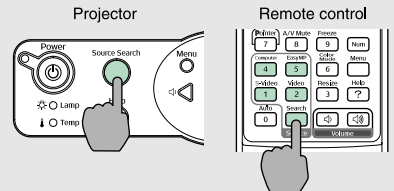

- If connecting to a computer with a built-in monitor, or to a laptop computer, you may need to change the output destination using the buttons or setting menus on the computer or laptop computer.

User's Guide "Turning the Power On and Projecting Images"

● Adjusting the image angle

While pulling the foot adjust lever, lift up the front of the projector so that the front adjustable foot can extend. To retract the front adjustable foot, gently push down on the projector while pulling the foot adjust lever.

Foot adjust lever

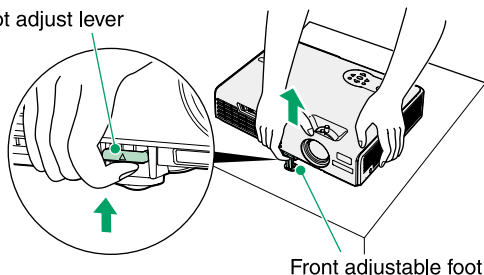

Front adjustable foot

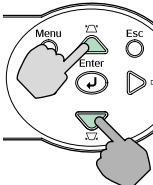
When the projector is tilted, it will cause keystone distortion to appear in the image, but this distortion can be corrected using the automatic keystone correction function as long as the vertical angle of tilt is within a range of approximately 15°. If you would like to make further minor adjustments to the result of automatic keystone correction, use  on the projector's control panel.

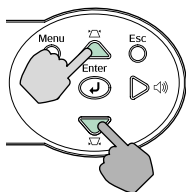

● Adjusting the image size and focus

Fine adjustments to image size

Turn the zoom ring to adjust the image size. Turn to the "W" side to increase the image size, and turn to the "T" side to reduce the image size.

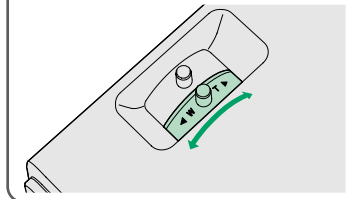

Adjusting the focus

Turn the focus ring to adjust the focus.

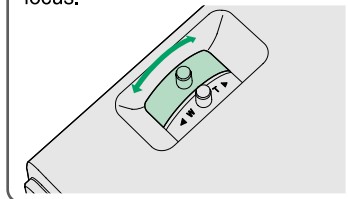

Tip

The following adjustments can also be made.

• Auto Setup (only when computer or RGB video signals are being projected)

 User's Guide "Adjusting Computer Images and RGB Video Images"

When projecting computer images, the input signals are detected automatically and adjusted so that the optimum images are projected. If the results of automatic adjustment are not satisfactory, individual settings can also be adjusted manually using the menus.

• Other adjustments User's Guide "Using the Configuration Menu Functions"

Press  on either the remote control or the projector to display the Configuration menu.

You can use the configuration menu functions to adjust setting such as brightness, contrast and colour.

Turning the Projector Off

1 Turn off the power for all sources connected to the projector.

2 Press  twice to turn off the power.

The Power indicator will flash orange (cool-down in progress/about 20 seconds).

If a message prompting you to clean or replace the air filter appears, follow the instructions in the message.



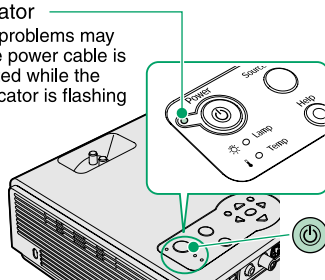

3 When the cool-down is complete, a "pip-pip" confirmation buzzer will sound, and the Power indicator will change to light orange.

Power indicator

Operating problems may occur if the power cable is disconnected while the Power indicator is flashing orange.



Useful Functions

Colour mode selection	The following six preset types of colour mode can be selected by pressing  on the remote control. <ul style="list-style-type: none"> • Dynamic • Living Room • Presentation • sRGB • Theatre • Blackboard 	 User's Guide "Selecting the Projection Quality (Colour Mode Selection)"
A/V Mute	Playback of images and sound can be momentarily paused and then resumed each time  on the remote control is pressed.	 User's Guide "A/V Mute"



Troubleshooting

 User's Guide "Troubleshooting"

Using the help function

1 Press .

2 Select the item to view.

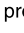
Tilt  on the remote control or press  and  on the projector's control panel to select an item.

3 Accept the selection.

Press  to confirm the selection of a menu item.

4 The help contents will then be displayed.

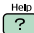
The help menu is cleared when  is pressed.

Checking the indicators

These indicators alert you to problems with projector operation. The following tables show what the indicators mean and how to remedy problems that they indicate.





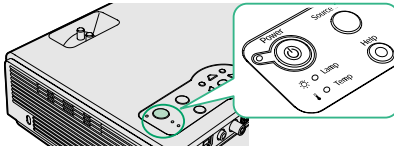







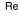

 Refer to "Problems Solving" in the *User's Guide* for further details.

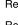
If all indicators are switched off, check that the power cable is connected correctly and that power is being supplied normally.

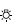

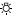
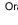
Problem/Warning

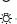
 Lit  Flashing  Off









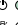

Status	Problem and remedy
 Red  Red  Red	High temperature inside projector (overheating) The lamp will turn off automatically and projection will stop. Wait for about 5 minutes. Then press  to turn the projector back on.
 Red  Red 	Lamp problem Remove the lamp and check if it is broken. If the lamp is not broken, reinsert it. If the lamp is broken replace it with a new lamp, or contact your local dealer for further advice. *1
 Red  Red  Red	Internal problem Stop using the projector and send it for service. *2
 Red  Red  Red	Something is wrong with the fan or the sensor. Stop using the projector and send it for service. *2
 Red  Red  Orange	High-speed cooling in progress. If the temperature rises too high again, projection will stop automatically. Check that the air filter and air exhaust vent are clear, and that the internal room temperature is not too high.
 Orange  Orange 	It is time to replace the lamp. Replace the lamp with a new one as soon as possible. If you continue to use the old lamp, the possibility that the lamp may break will increase.

*1 Contact your dealer for a spare lamp.

*2 For repairs, contact your dealer or the nearest address provided in the "International Warranty Conditions" section in the *Safety Instructions/World-Wide Warranty Terms* booklet.

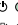
Normal

 Lit  Flashing  Off

Status	Problem and remedy
 Orange  Orange 	Standby condition The power cable should only be disconnected in this condition. Projection starts when you press  .
 Green 	Warm-up in progress After warm-up finishes, projection starts when an image signal is input.
 Green 	Projection in progress
 Orange  Orange 	Cool-down in progress The projector changes to standby (indicator lights orange) after about 20 seconds.