

Setup Guide

1 Setting up

Adjust the projection size.

The size of the projected image is basically determined by the distance from the projector's lens to the screen.

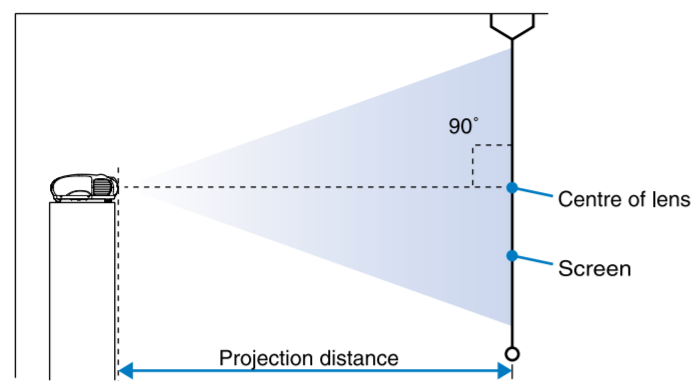

The height from the centre of the lens to the bottom of the screen will vary depending on the lens shift setting.

While referring to the table below, position the projector so that the images are projected onto the screen at the optimum size. The values should be used as a guide for setting up the projector.

Units: cm (in.)		Units: cm (ft.)		Units: cm (in.)		Units: cm (ft.)	
16:9 screen size	Projection distance		4:3 screen size	Projection distance			
	Shortest (Zoom adjustment: Wide)	Longest (Zoom adjustment: Tele)		Shortest (Zoom adjustment: Wide)	Longest (Zoom adjustment: Tele)		
30"	66 × 37 (26 × 14)	87–133 (2.9–4.4)	30"	61 × 46 (24.0 × 18.1)	108–164 (3.6–5.4)		
40"	89 × 50 (34 × 19)	118–179 (3.9–5.9)	40"	81 × 61 (31.9 × 24.0)	146–220 (4.8–7.2)		
60"	130 × 75 (52 × 29)	179–270 (5.9–8.9)	60"	120 × 90 (47.2 × 35.4)	221–332 (7.2–10.9)		
70"	154 × 87 (61 × 34)	209–316 (6.9–10.4)	70"	142 × 106 (55.9 × 42.0)	258–388 (8.5–12.7)		
80"	180 × 100 (69 × 39)	240–361 (7.9–11.9)	80"	160 × 120 (63.0 × 47.2)	295–443 (9.7–14.6)		
100"	220 × 120 (87 × 49)	301–452 (9.9–14.8)	100"	200 × 150 (78.7 × 59.1)	370–555 (12.2–18.2)		
200"	440 × 250 (174 × 98)	606–909 (19.9–29.8)	200"	410 × 300 (161.4 × 118.1)	745–1114 (24.4–36.5)		
300"	660 × 370 (261 × 147)	911–1365 (29.9–44.8)	300"	610 × 460 (240.2 × 181.1)	1119–1672 (36.7–54.9)		

Projection methods

When projecting from directly in front

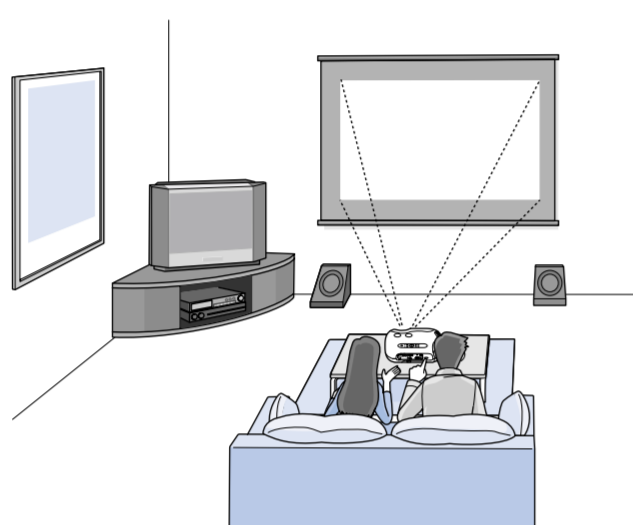

When projecting from the side of the screen

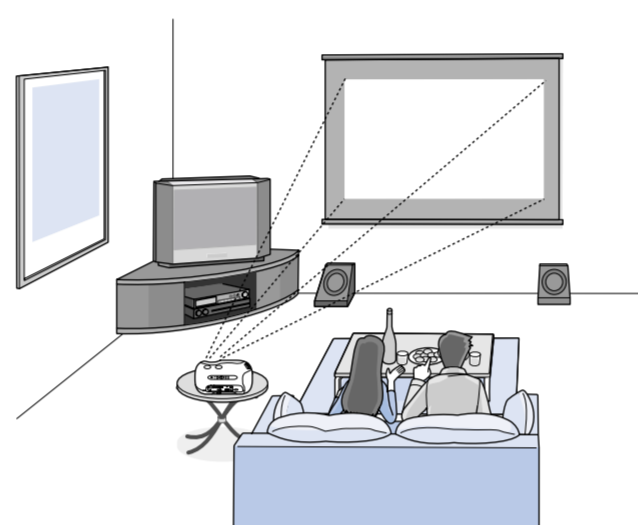

When projecting from a ceiling

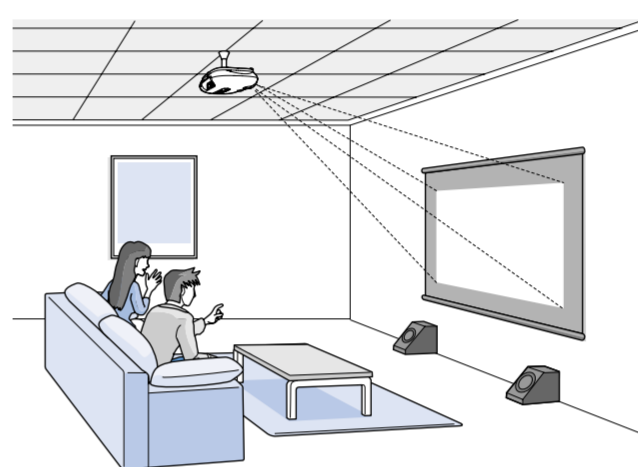

When suspending the projector from a ceiling, change the configuration menu settings.

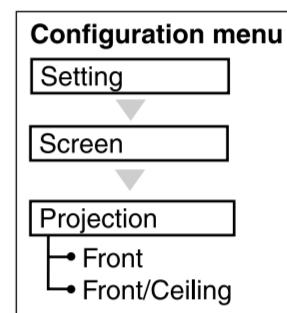

- Avoid setting the projector up in places which are very dusty such as bedrooms. Clean the air filter at least once every 3 months. Clean the air filter more frequently if using the projector in a dusty environment.
- When installing against a wall, leave a space of 20 cm (7.9 in.) or more between the projector and the wall.
- A special method of installation is required in order to suspend the projector from the ceiling. Please contact your dealer if you would like to use this installation method.

Lens shift adjustment

The lens shift dials can be used to position the image and is especially useful when using the projector in the following locations.

- Hanging from the ceiling
- A screen in a high location
- Projector situated to the side so that the screen can be viewed sitting right in front of it
- Projector situated on a shelf, etc.

When positioning an image using the lens shift dial, hardly any deterioration of the image occurs because the lens shift correction is adjusted optically. However, for optimal image quality the lens shift function should not be used.

⚙️ "5 Adjusting the projection screen" - Projection image position adjustment (Lens shift)

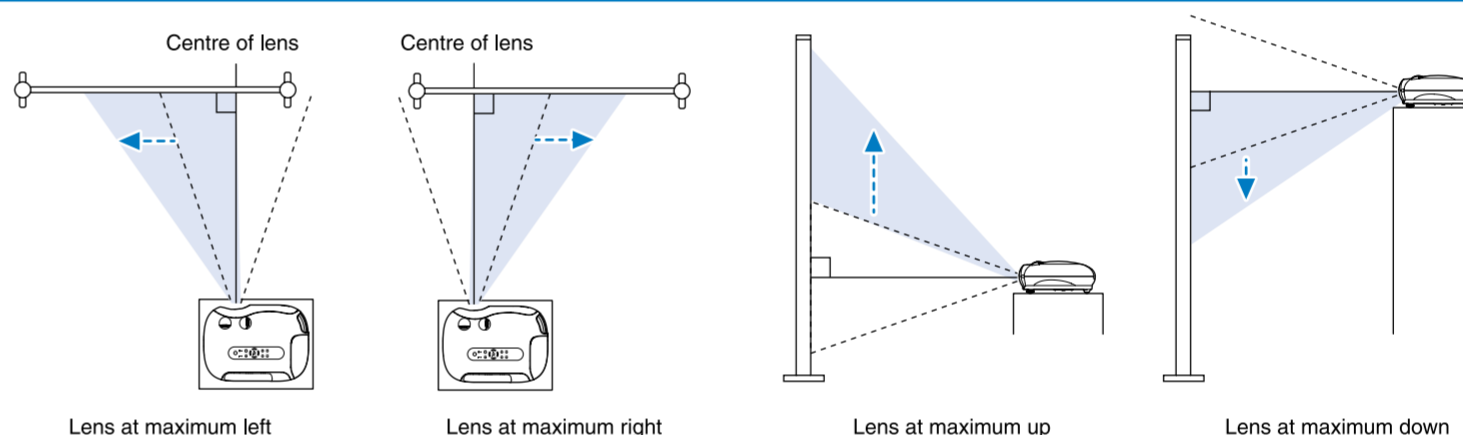

* The dotted lines indicate the projection range from the lens centre position.

2 Connecting image sources

- Turn the power off for both the projector and the signal source before connecting them. If the power for either device is on at the time of connection, damage may result.
- Check the shapes of the cable connectors and the device ports before making the connections. If you try to force a connector to fit a device port with a different shape or number of terminals, a malfunction or damage to the connector or port may result.

💡 Some signal sources may have specially-shaped ports. In such cases, use the accessory or optional cables that are supplied with the signal source to make the connections.

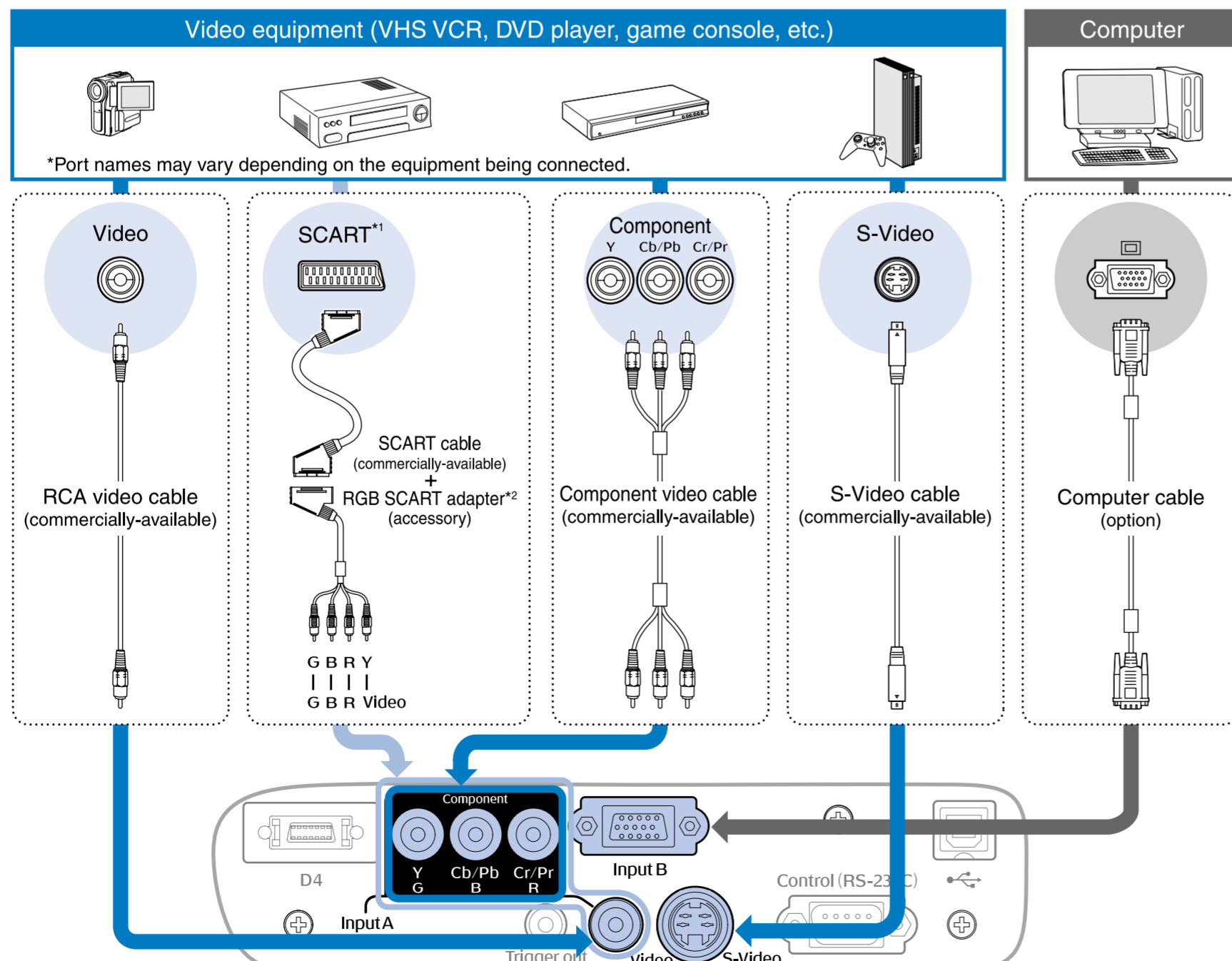

*1 If a DVD has been connected using an RGB SCART adapter, change the "InputA" setting to "RGB-Video". ⚙️ Selecting the image source in 4.
*2 Some regions may not have the RGB SCART adapter included as an accessory.

3 Remote control preparation

Inserting batteries into the remote control

The remote control is not supplied with batteries already inserted. Insert the accessory batteries before using the remote control.

- 1 Remove the battery cover.
- 2 Insert the batteries. Check the (+) and (-) indications inside the battery compartment and insert the batteries so that they face correctly.
- 3 Install the battery cover.
 - 1 Insert the tab.
 - 2 Press down until the battery cover clicks into place.

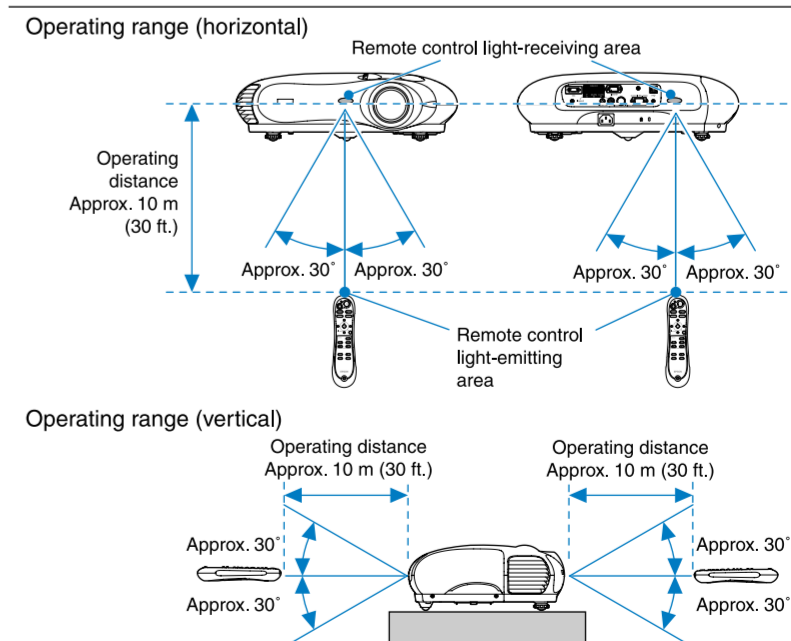

Battery replacement period

If delays in the responsiveness of the remote control occur or if it does not operate after it has been used for some time, it probably means that the batteries are becoming flat. If this happens, replace the batteries with two new batteries. Use two new AA alkaline batteries as replacement batteries.

4 ▶ Turning the power on and projecting images

- 1 Remove a lens protective pad.
(If the lens cover has been installed, remove it.)

- Before using the projector, be sure to remove a protection pad attached to the lens.
- Store the protection pad. It will be needed when transporting the projector.
- When transporting the projector, set the lens position to the centre and attach the protection pad before packing. The lens may be damaged during the transport if the protection pad is not used. If you lose the protection pad and need to transport the projector, set the lens to the lowest position.

- 2 Use the accessory power cable to connect the projector to an electrical outlet.
- 3 Turn the power on for the signal source (for a video source, press the [Play] button to start playback).
- 4 Turn the power on for the projector.
After a short period, the lamp will turn on and projection will start.

The projector is equipped with a "Child Lock" function that prevents young children from accidentally turning the power on and looking into the lens, and also a "Lock Setting" function that prevents mis-operations.
☞ User's Guide: "Configuration Menu Functions"

- This projector is equipped with an automatic adjustment function that automatically optimizes it when the RGB video source or a computer input signal is switched.
- If a laptop computer or a computer with a LCD screen has been connected to the projector, you may need to use keyboard or function settings to change the output destination. While holding down the [Fn] key, press [F4] (the key with a symbol such as □ / ○ on it). After the selection is made, projection will soon start.
☞ Computer documentation

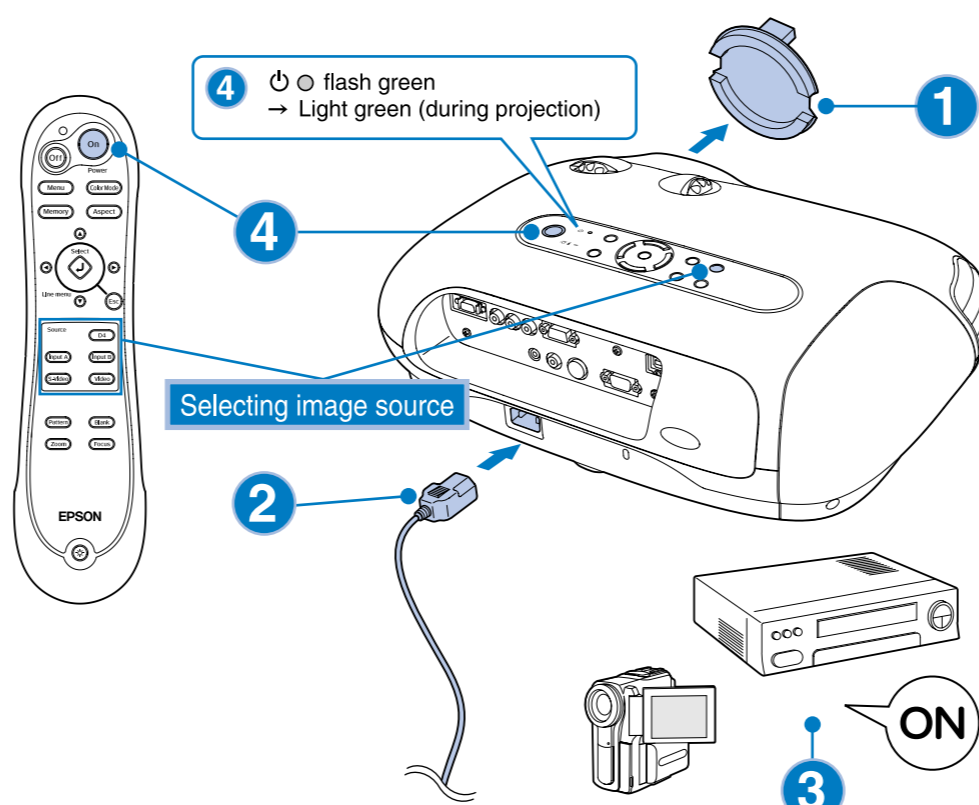

■ Selecting the image source

If more than one signal source has been connected, or if no images are projected, use the remote control or the projector's control panel buttons to select the signal source.

● Using the remote control

Press the button that has the name of the port on it that the desired signal source is connected to.
When connecting equipment to the [D4] port or [InputA] port, you may need to switch the image signal to match the equipment.

Default setting: [D4] port: YCbCr [InputA] port: YCbCr

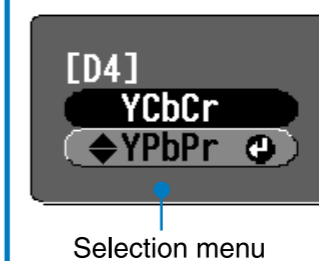

Selection menu

While projecting an image from equipment connected to the [D4] or InputA port(s), press the [D4] or [Input A] button to display the selection menu. Use the [Left] [Right] button to select the correct signal to match the equipment. Press [Enter] to accept.

● Selecting using the projector's control panel

When you press [Source], the selection menu is displayed. Use [Left] [Right] to select the signal source. Press [Enter] to accept.

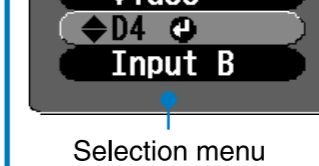

Selection menu

If "D4" or "InputA" is selected, a menu for selecting the signal format will be displayed. Select the one that matches the image signal of the connected equipment.

Example of output selection	
NEC	[Fn] + [F5]
Panasonic	[Fn] + [F6]
Toshiba	[Fn] + [F7]
IBM	[Fn] + [F8]
SONY	[Fn] + [F9]
Fujitsu	[Fn] + [F10]
Macintosh	Set mirror setting or display detection.

? Signal source cannot be selected / Images are not projected correctly

If there is a problem with projection even though the projector is set up and connected correctly, check the following points. If the following points fail to solve the problem, refer to "When the Indicators Provide No Help" in the User's Guide.

<p>A connected signal source cannot be selected.</p>	Do the input signal settings match the projector settings? When connected to the [InputA] port	Press [Input A] or [Source] to select the signal format that matches the signal source.
	Are images being played back by the signal source?	Press the [Play] button to start playback on the video equipment.
	Has the VCR been connected using an RGB SCART adapter?	Press [Video] to switch the image source to Video.
	Has the DVD been connected using an RGB SCART adapter?	Change the setting at the DVD to RGB output.

<p>Images appear greenish or purplish</p>	Do the input signal settings match the projector settings? When connected to the [InputA] port	Press [Input A] or [Source] to select the signal format that matches the signal source.
---	---	---

5 ▶ Adjusting the projection screen

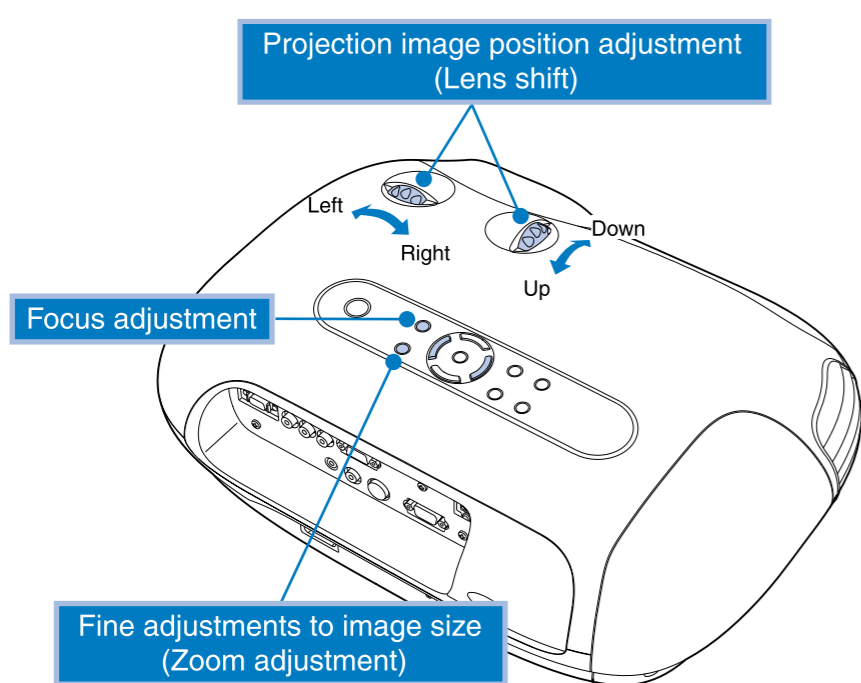

Projection image position adjustment (Lens shift)

Focus adjustment

Fine adjustments to image size (Zoom adjustment)

- When [Zoom] or [Focus] is pressed, a [Lock] will be displayed on the screen and if adjustment is not possible, it means that "Zoom Lock" or "Focus Lock" is operating. Turn the lock function off if you would like to make adjustments.
☞ User's Guide: "Configuration Menu Functions"

Zoom adjustment and focus adjustment are performed after the lamp lights. If you push [Focus] or [Zoom] once it adjusts one step, and holding it adjusts it continuously.

Focus adjustment

Press [Focus] to display the adjustment screen.
Press [Left] and [Right] to adjust the focus.
If you press [Focus] once more, the adjustment screen will disappear. Adjustment can also be carried out while the test pattern is displayed.

Projection image position adjustment (Lens shift)

Use the two lens shift dials to adjust the image position. When the lens shift dial is turned, a point of resistance will be felt. This indicates the approximate centre point for the range of adjustment. In addition, if the lens shift dial becomes hard to turn further and the image position stops changing, no further adjustment is possible.
☞ "Setting up" - Lens shift adjustment
If you cannot position the projector straight in front of the screen, use the horizontal lens shift dial so that the image is centered on the screen.

Fine adjustments to image size (Zoom adjustment)

Press [Zoom] to display the adjustment screen.
Press [Left] and [Right] to adjust the zoom.
If you press [Zoom] once more, the adjustment screen will disappear. Adjustment can also be carried out while the test pattern is displayed.

■ Displaying a test pattern

You can project a test pattern at times such as when setting up the projector in order to correct keystone correction and to make line menu adjustments. You can also adjust the zoom and focus using the test pattern.

If [Pattern] on the remote control is pressed, the pattern selection menu appears.

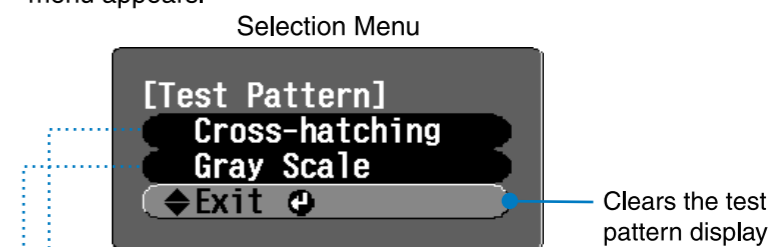

● Cross-hatching

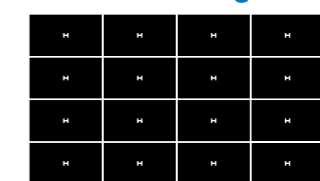

This can be used to check whether the projector is tilted or set up vertically in front of the screen.

● Grey Scale



This is used when adjusting brightness or when adjusting image quality or colour tone. The adjustment is made using the line menu. Adjustment is not possible when no image signals are being input.

■ Correcting projector tilt

If the projected images are tilted horizontally, use the front adjustable feet to adjust the projector so that it is horizontal.

To extend the feet, stand behind the projector and rotate them outward with both hands. Note that the feet are designed to turn in different directions.

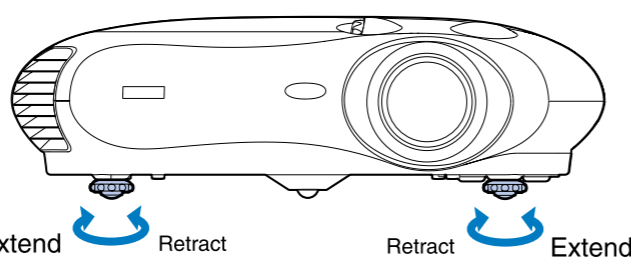

■ Correcting keystone distortion (Keystone)

When you wish to adjust the projection above or below the range of lens shift adjustment set the projector at an angle.

When the projector is angled, the projected image may distort into a trapezoid. In such cases, press [Left] [Right] on the projector's control panel to adjust the images. However, the image quality will decrease compared to if the lens shift function is used.

When the lens is shifted to the left or right, complete keystone correction is not possible. When making keystone corrections set the lens at the center left to right.

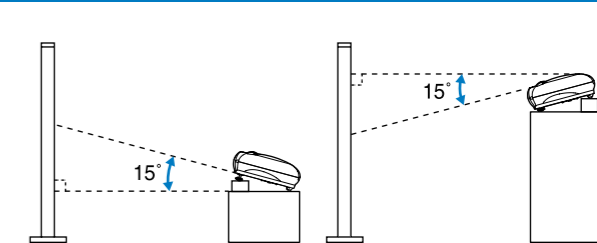

Keystone distortion can be corrected within a maximum vertical angle of approximately 15°.

6 ▶ Turning the power off

- 1 Turn the power off for the signal sources that are connected to the projector.

- 2 Press [Power] on the remote control or [Power] on the projector.

When [Power] is pressed, the message at right is displayed, so press [Power] once more.

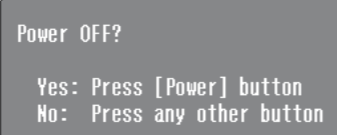

The [Flash] indicator will flash orange and the cool-down period will start. You cannot use the remote control or the projector's control panel during cool-down (takes approximately 30 seconds). After cool-down is complete, the [Flash] indicator changes to steady orange and the projector goes to standby mode.

If the projector is on a surface such as a tabletop, the surface of the table near the air outlet will become hot.

- If the message "The projector is overheating. Make sure nothing is blocking the air vent, and clean or replace the air filter." is displayed, press [Power] or [Power] to turn the power off, and then do as instructed in the message.

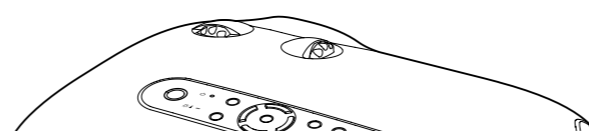

- 3 Attach the lens cover.

Attach the lens cover when not using the projector in order to keep the lens free from dust and other foreign objects.

- 4 When the projector will not be used for long time, disconnect the power cable from the electrical outlet.

Always make sure that the projector is in the standby condition before disconnecting the plug. After the power plug is disconnected, the [Flash] indicator will continue to light for a brief period and then it will turn off.

- 5 Disconnect the cables that are connecting other equipment to the projector.